



CLINICAL  
VALIDATED

# BPBIO750

The automatic blood pressure monitor inducing correct measurement posture



## Moving cuff, Moving elbow sensor

Inducing correct posture for  
correct measurement

## Smart Interface

Convenient interface to measure  
personally, even without managers

## Measurement of both arms

Convenient to measure both arms  
with the ergonomic design

Automatic blood pressure monitor

## BPBIO750

BPBIO750 overcame the limitations of existing blood pressure monitors that are difficult to pose correctly through the moving cuff and moving elbow sensor.



## Simple and sophisticated four point colors

**Lime Green**

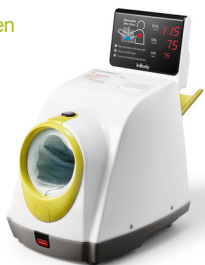

**Cotton Blue**



**Tangerine Orange**



**Cozy Gray**



## Accessories



## BPBIO750 features

- 1 Moving cuff**  
Inducing correct posture in close contact with measuring arm
- 2 Moving elbow sensor**  
Inducing correct settlement of the elbow by reflecting the shape of measuring arm
- 3 Guide-display**  
Convenient Interface for personal measurement
- 4 Convenient to measure both arms with the ergonomic design**
- 5 Large screen**  
Excellent visibility for systolic blood pressure, diastolic blood pressure, and pulse rate
- 6 Selectable Result Sheets**  
Pulse envelope, blood pressure result graph, confirmation of measurement posture, the common sense of blood pressure, and logo are insertable when printing selectable type of Result Sheets.

Result Sheets to select output options

<b>InBody</b>	2017.06.27
SYSTOLIC	115 mmHg
DIASTOLIC	75 mmHg
PULSE	75 bpm
M.A.P	88 mmHg
P.P	40 mmHg
R.P.P	8625

Basic Result Sheets

<b>InBody</b>	2017.06.27
SYSTOLIC	115 mmHg
DIASTOLIC	75 mmHg
PULSE	75 bpm

Small Result Sheets

<b>InBody</b>	2017.06.27
SYSTOLIC	115 mmHg
DIASTOLIC	75 mmHg
PULSE	75 bpm

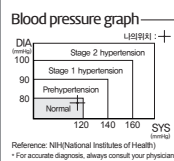
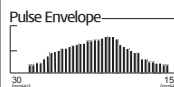

**Check posture**  
The elbow position is incorrect. Put your elbow into the grooves as shown in the figure below.



**Motion detection**  
An irregular blood pressure signal was detected. Do not speak or move during measurement.

**Blood pressure knowledge**  
Blood pressure can fluctuate about 30 mmHg throughout the day. Compare your blood pressure with measurements taken around the same time on other days.

**InBody**  
See what you're made of

- 7 Hygienic management**  
Convenient removable cuff-cloth
- 8 Automatic power saving function**  
Entering to sleep mode when waiting more than 2 minutes
- 9 Easy to control back button for administrator**  
Convenient Start/Stop button on front and back of BPBIO750
- 10 Irregular pulse wave detection**

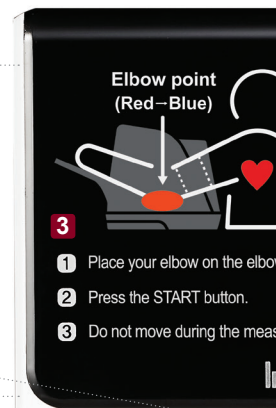





**Moving cuff** and **moving elbow sensor** in BPBIO750 help patients wear the cuff correctly even without managers.

This is InBody's unique technology that induces correct posture for accurate measurement value.

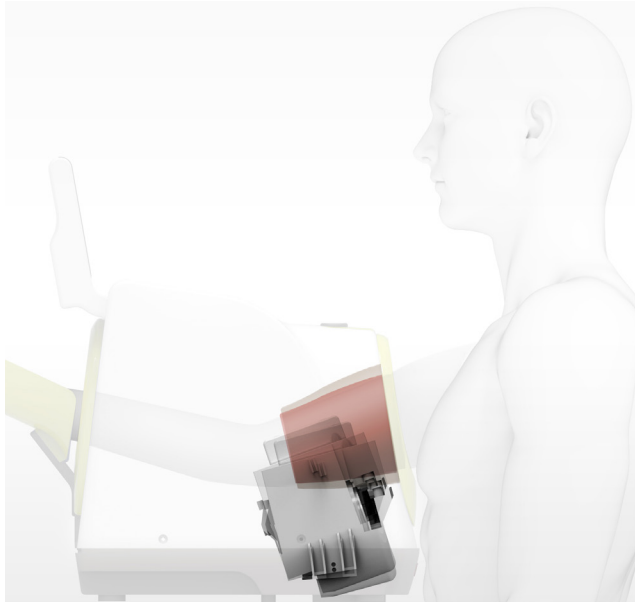

**The moving cuff** helps wear accurately, even if the person's posture is not correct.

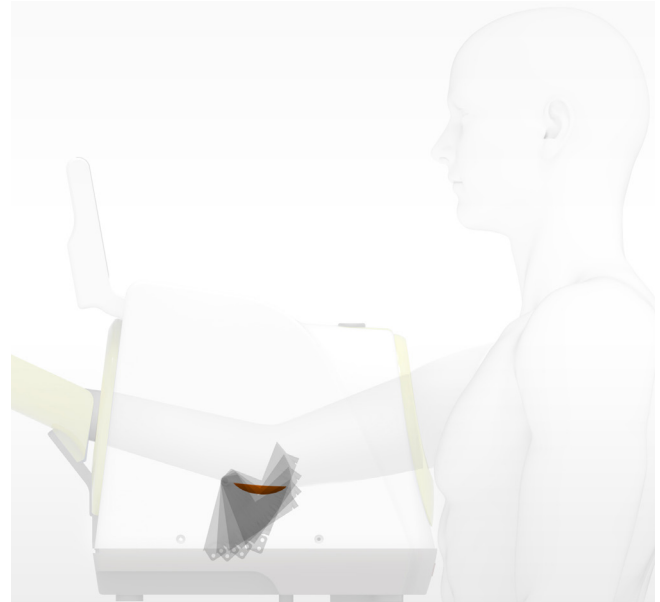

**The moving elbow sensor** leads the elbow to correct position by sensing the contact of the elbow

\* Patent registration number: 10-2016-0036313

Excellent visibility is fundamental!

**The guide-display** helps blood pressure measurement to be convenient even alone.

This guide-display guides the sequence of blood pressure measurement.

You can easily measure blood pressure, according to guide from BPBIO750 without medical personnel.



# BPBIO750 Specifications

## Core specifications

Measurement Method	Oscillometric method
Pressurization method	Automatic adjustment by air pressurization speed controller and micro pump Pressurization
Decompression method	Automatic adjustment by air decompression speed controller and micro valve Decompression
Exhaust	Automatic rapid exhaust method
Cuff	Pressing belt system by geared motor, automatic operation
Range of measurement	0~300 mmHg(Pressure), 30~240 bpm(Pulse), 17~42 cm(Arm circumference)
Degree of precision	Pressure $\pm 3$ mmHg, pulse within $\pm 2\%$
Measurement results	Systolic blood pressure, diastolic blood pressure, pulse rate, pulse pressure, mean blood pressure, rate pressure product
Measurement time	Approx. 30 seconds on average (20-50 seconds depending on the pulse and blood pressure value)
Pressurization time	Approx. 10 seconds
Minimum scale unit	1 mmHg

## Functional specifications

Display method (Screen type)	7-Segment LED
Display contents	Measurement guide, elbow detection, measurement result value, irregular blood pressure signal detection, and time
Human body detection sensor	A sensor to detect human presence in front of device
Moving elbow sensor	Equipped with a fluid structure for the accurate elbow detection (Patent registered)
Moving cuff	Equipped with a fluid structure to induce accurate measurement posture
Result Sheets	Selectable for measurement values, graph, common sense for blood pressure, or correct posture guide
Error display	Outputting error message on Results Sheets and display screen
Checking the number of measurements	The number of measurements per day, the total number of cumulative measurements
Voice guidance	Guiding the blood pressure measurement and the result after measurement
Background music	Playing background music when adjusting volume
Printer	High-speed thermal printer with the built-in automatic cutter (width: 2.5-inch)
Start/Stop button	Two Start/Stop buttons in front and rear bottom sides,
Emergency exit button	Emergency exit button in front bottom side
Safety mechanism	Quick cuff release and exhaust by pressing the Start/Stop button Automatically release and exhaust the cuff when the air pressure exceeds 300 mmHg Quick cuff release and exhaust by pressing the Emergency exit button (The dual safety mechanism enables the cuff to release and exhaust regardless of the central controller when the Emergency exit button is pressed.)
External interface	RS232C (USB compatible when USB dedicated cable is used)
Accessories	Dedicated desk, height-adjustable dedicated chair

## Other specifications

Power source	AC 100~120 / 200~240V, 50 / 60Hz, 36VA
Dimensions	Approx. 299 (W) $\times$ 547 (D) $\times$ 485 (H) mm
Weight	Approx. 7.1 kg (Package weight: Approx. 11.3 kg)
Optional device	Desk: Approx. 12.0 kg, Chair: Approx. 5.3 kg
Operating	10~40°C, 30~75% RH, 70~106 kPa
Storage	-10~70°C, 10~80% RH, 50~106 kPa (No Condensation)

- \* For purposes of improvement, specifications are subject to change without notice.
- \* This product is a 'medical equipment'. Please read the guide and cautions before using this blood pressure monitor.

### Certifications and patents acquired by InBody

InBody is the first body composition analyzer in Korea to obtain the European and Japanese meter approval and holds a total of about 80 patents worldwide.

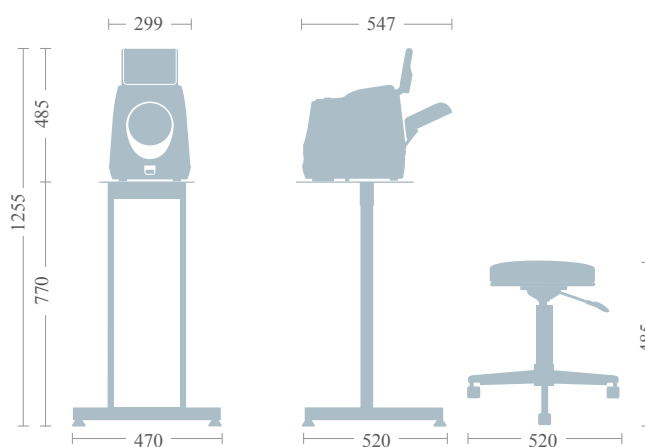

## InBody

### InBody HQ [KOREA]

InBody Co., Ltd.

625, InBody Bldg., Eonju-ro, Gangnam-gu, Seoul 06106 Republic of Korea

TEL: +82-2-501-3939 FAX: +82-2-578-5669 Customer Center: 1899-5841

Website: <https://inbody.com> E-mail: [info@inbody.com](mailto:info@inbody.com)